

Vendor Mapping: To scan pre-packaged fresh fruit, vegetables, and herbs at the cash register, vendors must map all pre-packaged and store packaged produce UPCs to a PLU for the same kind of item.

A list of PLU codes can be found in the “**UPC Information**” section of www.nyswicvendors.com

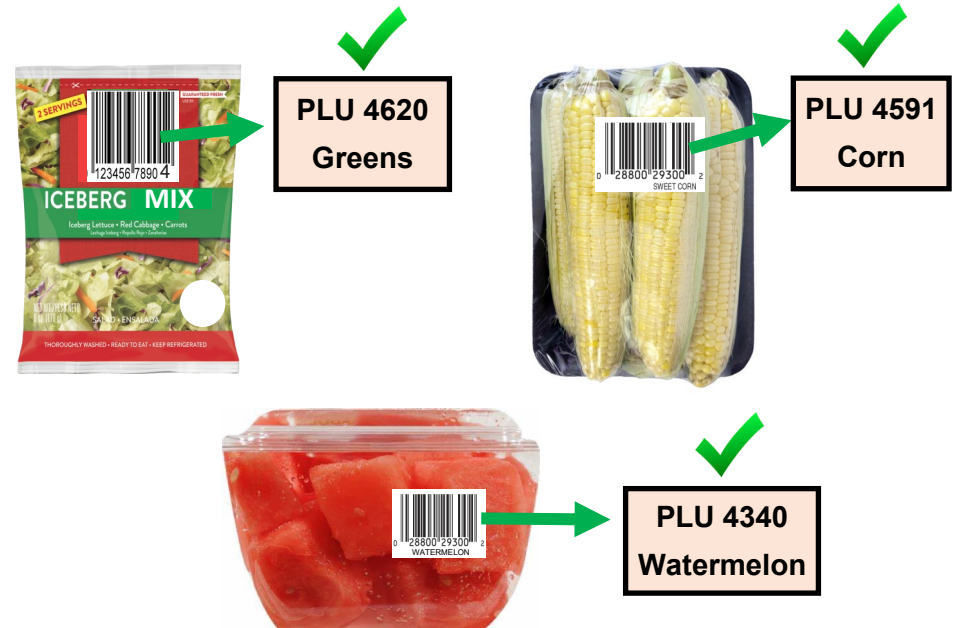

Do not use the WIC2Go mobile app to scan fresh produce UPCs.

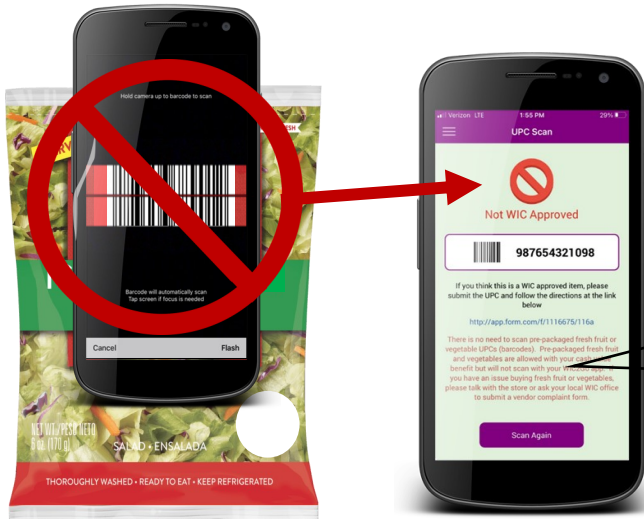

Pre-packaged fresh produce **is allowed** but will always scan as “Not WIC Approved” with the **WIC2Go mobile app.**